



Howard P. Milstein
Chairman

New York State Thruway Authority
New York State Canal Corporation

200 Southern Boulevard, Post Office Box 189
Albany, New York 12201-0189
www.thruway.ny.gov
(518) 436-2700



Thomas J. Madison, Jr.
Executive Director

January 3, 2013

Mr. John Ferguson
New York State Department of Environmental Conservation
625 Broadway
Albany, NY 12233

Re: NYSDEC Permit No. 3-9903-00043/00011 New NY Bridge Project (formerly known as the Tappan Zee Hudson River Crossing Project) Supplement to the March 26, 2012 Joint Permit Application: Revised Design Drawings

Dear Mr. Ferguson:

On behalf of the New York State Thruway Authority (NYSTA), attached is supplemental information for the New NY Bridge Project (formerly known as the Tappan Zee Hudson River Crossing Project). The attached drawings supersede those included in Attachment 4 under cover of the December 17, 2012 Supplement to the March 26, 2012 Joint Permit Application. Since the December 17, 2012 submission, the design plans have been refined. The differences between the design plans submitted in the December 17, 2012 submission and those included under cover of this letter include the following:

- The bulkhead design, as shown on Sheet 7 of 15, has been revised to eliminate any fill.
- The Permanent North Dock shown on Sheet 7 of 15 has been reduced to 106,435 square feet (2.44 acres) from 150,000 square feet (3.44 acres), as shown on previous drawings.
- The Temporary Rockland County Trestle deck totals have been recalculated to reflect 144,140 square feet (3.31 acres). This includes the area that will become the Temporary North Trestle (88,440 square feet [2.03 acres]), the Temporary Walkway (5,700 square feet [0.13 acres]), and the Temporary South Trestle (50,000 square feet [1.15 acres]). This total area represents an increase of 2.48 acres of temporary overwater coverage from the area shown on the previous drawings. Although the total overwater platform coverage would be more than the previous drawings, the revised design is less than what was originally estimated for the Replacement Bridge Alternative as presented in the July 2012 Final Environmental Impact Statement (FEIS).

The total overwater platform acreage for both temporary and permanent platforms combined has been reduced to 9.13 acres from 12.57 acres as identified in the FEIS.

- The Temporary Rockland Bridge Staging Area dock remains the same as identified in the previous drawings.
- The Temporary Westchester North and South Trestle acreages remain the same as identified in the previous drawings.
- The amount of armoring has been reduced from the volume that was presented on previous drawings. As shown on Sheet 10 of 15, the armoring volume has been reduced to 0.36 million cubic yards from the 0.65 acres shown in the previous drawings and the 0.56 million cubic yards evaluated in the FEIS.

The attached drawings and revised impact tables are also being submitted to the New York State Department of State (NYSDOS) for an updated consistency review under the New York State Coastal Management Act.

Should you have any questions or require additional information, please do not hesitate to contact me at Elizabeth.Novak@thruway.ny.gov or (518) 436-3190.

Sincerely,



Elizabeth K. Novak

Attachments:

Attachment 1: JPA Drawings

Attachment 2: Revised Impact Tables

cc: M. Toni and J. Burns (FHWA); P. Casper and M. Shamma (NYSTA); M. Anderson and K. Edwards (NYSDOT); J. Zappieri (NYSDOS); E. McTiernan (NYSDEC); R. Conway (AKRF); D. Paget and A. Stolorow (SPR)

List of Attachments

Attachment 1: JPA Drawings
Attachment 2: Revised Impact Tables

Attachment 1: JPA Drawings

LOCATION MAP

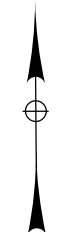
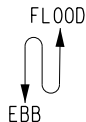
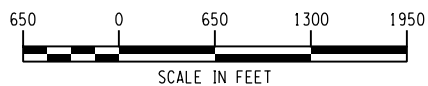

PROJECT MANAGER

CHECK

DRAFTING

CHECK

DESIGN

JOB MANAGER

DESIGN SUPERVISOR

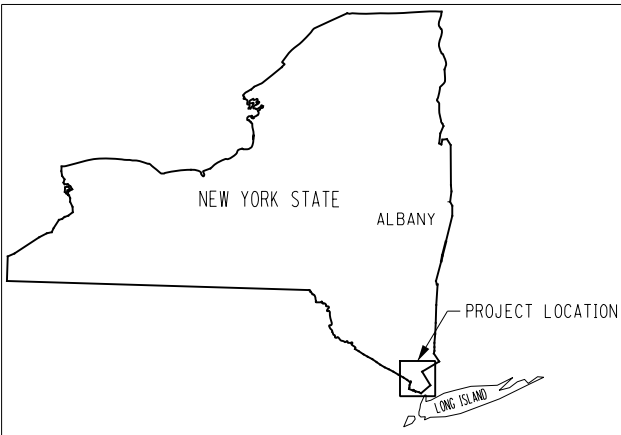
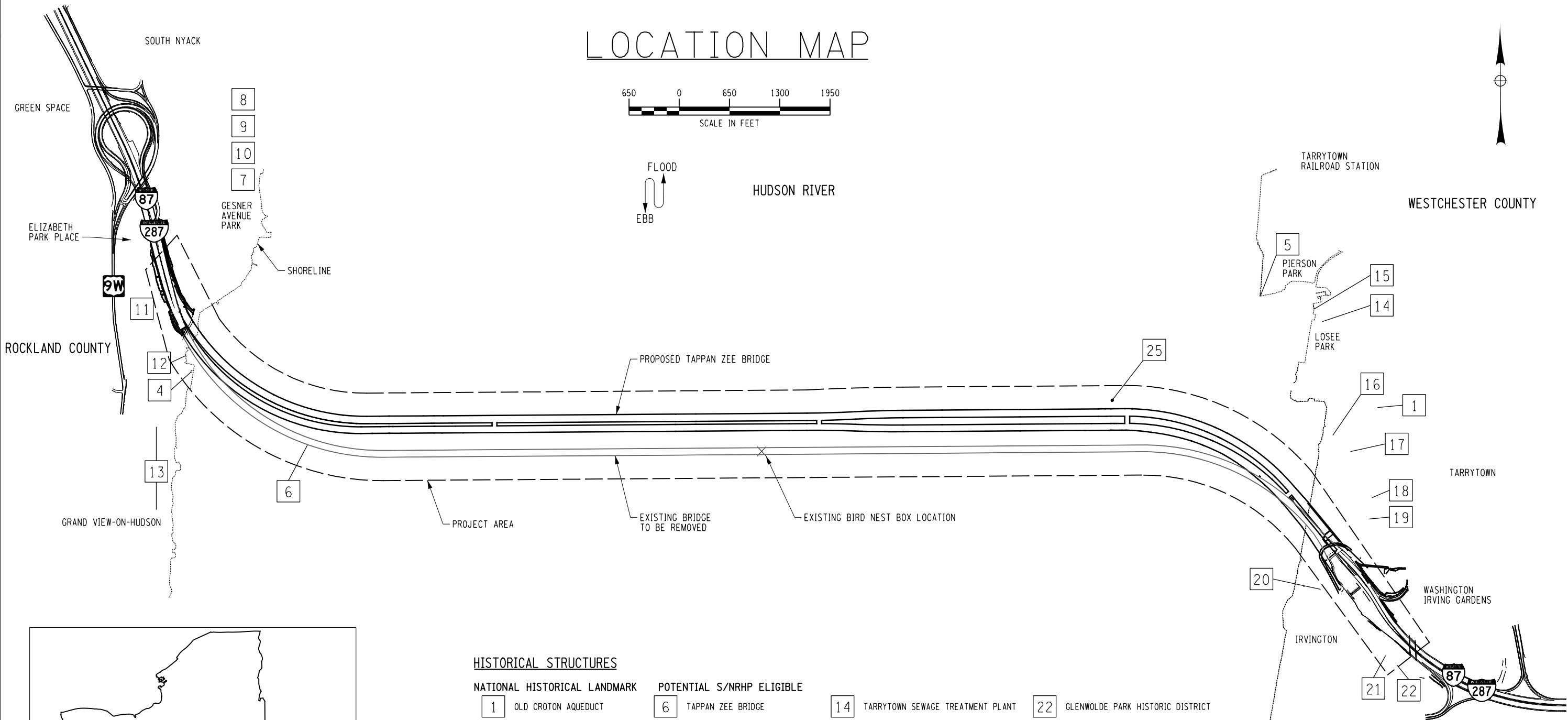

HISTORICAL STRUCTURES

NATIONAL HISTORICAL LANDMARK

- 1 OLD CROTON AQUEDUCT
- 2 LYNDHURST
- 3 SUNNYSIDE

S/NRHP LISTED

- 4 WAYSIDE CHAPEL
- 5 TARRYTOWN LIGHTHOUSE

POTENTIAL S/NRHP ELIGIBLE

- 6 TAPPAN ZEE BRIDGE
- 7 SOUTH NYACK HISTORIC DISTRICT
- 8 129 PIEMONT AVENUE
- 9 135 PIEMONT AVENUE
- 10 147 PIEMONT AVENUE
- 11 2 SHADYSIDE AVENUE
- 12 10 FERRIS LANE
- 13 RIVER ROAD HISTORIC DISTRICT

- 14 TARRYTOWN SEWAGE TREATMENT PLANT
- 15 TARRYTOWN RAILROAD STATION
- 16 TAPPAN LANDING HISTORIC DISTRICT
- 17 WASHINGTON IRVING GARDENS
- 18 99 WHITE PLAINS ROAD
- 19 100 WHITE PLAINS ROAD
- 20 IRVING HISTORIC DISTRICT
- 21 HOPE UNITED PRESBYTERIAN CHURCH

- 22 GLENWOLDE PARK HISTORIC DISTRICT
- 23 NEW COUNTY PARK
- 24 SOUTH END HISTORIC DISTRICT
- 25 SHIPWRECK TARGET 001

NOTES:
1. BIRD NEST BOX TO BE RELOCATED PER PERMIT CONDITIONS.



SIGNATURE _____ DATE _____

TAPPAN ZEE BRIDGE
HUDSON RIVER, MILEPOINT 27
SOUTH NYACK-TARRYTOWN, NEW YORK
ROCKLAND AND WESTCHESTER COUNTIES

ALL DIMENSIONS IN FT UNLESS OTHERWISE NOTED
LOCATION MAP

CONTRACT NUMBER
D214134
SHEET NO. 1 OF 15

FILE NAME : c:\pwworking\pitt\0704876\JPA-001.dgn
DATE/TIME : 12-27-2012 5:26:45 PM
USER : hshin

FILE NAME : c:\pwworking\pitt\0704876\JPA-002.dgn
 DATE/TIME : 12-27-2012 5:26:52 PM
 USER : hshn

PROJECT MANAGER
 CHECK
 DRAFTING
 CHECK
 DESIGN
 JOB MANAGER
 DESIGN SUPERVISOR

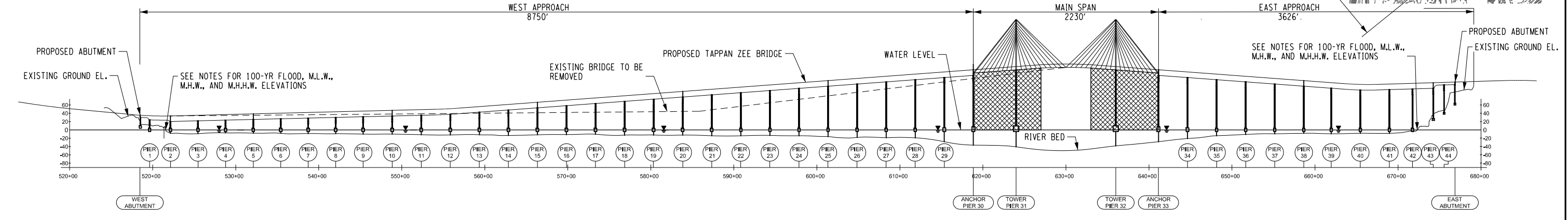
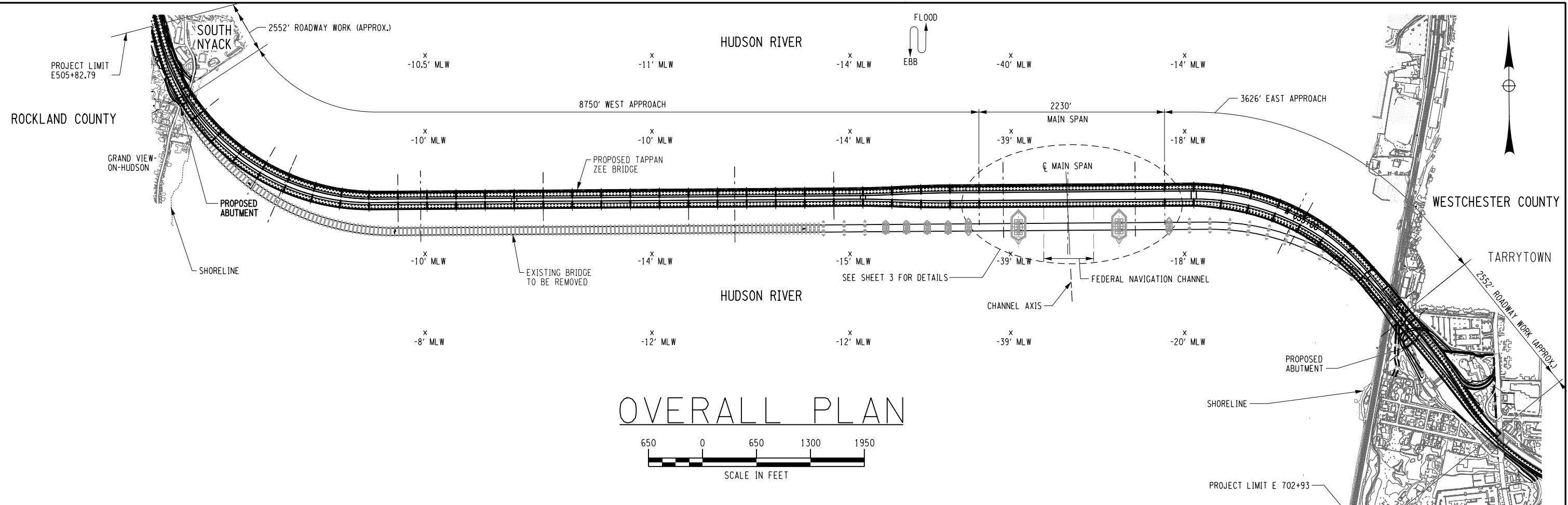

- NOTES:
1. HORIZONTAL DATUM: NAD83
 2. VERTICAL DATUM: NAVD88
 3. TIDAL DATUM:
 M.L.W. = EL. -1.69'
 M.H.W. = EL. +1.76'
 M.H.H.W. = EL. +2.02'
 4. WIDTH OF APPROACH STRUCTURE: VARIES (219' TO 279')
 5. WIDTH OF MAIN SPAN STRUCTURE 279'
 6. FEMA MAP 100-YEAR FLOOD ELEVATION: EL. 7' NAVD88
 7. REMOVE TO 2 FEET BELOW MUDLINE: ALL WOOD PILE-SUPPORTED PIERS AND CAISSON-SUPPORTED PIERS
 8. REMOVE TO 2 FEET BELOW GRADE: ALL LAND-BASED PIERS AND ABUTMENTS
 9. SPOT SOUNDINGS ARE BASED ON HYDROGRAPHIC SURVEY DATED JANUARY 2012, PREPARED BY S.T. HUDSON ENGINEERING.

OVERALL ELEVATION

650 0 650 1300 1950
 SCALE IN FEET



SIGNATURE _____ DATE _____

TAPPAN ZEE BRIDGE
 HUDSON RIVER, MILEPOINT 27
 SOUTH NYACK-TARRYTOWN, NEW YORK
 ROCKLAND AND WESTCHESTER COUNTIES

ALL DIMENSIONS IN FT UNLESS OTHERWISE NOTED

CONTRACT NUMBER
 D214134

OVERALL PLAN AND ELEVATION

SHEET NO. 2 OF 15

FILE NAME : c:\pwworking\pitt\0704876\JPA-003.dgn
 DATE/TIME : 12-27-2012 5:58:34 PM
 USER : mdecoco

PROJECT MANAGER

CHECK

DRAFTING

CHECK

DESIGN

JOB MANAGER

DESIGN SUPERVISOR

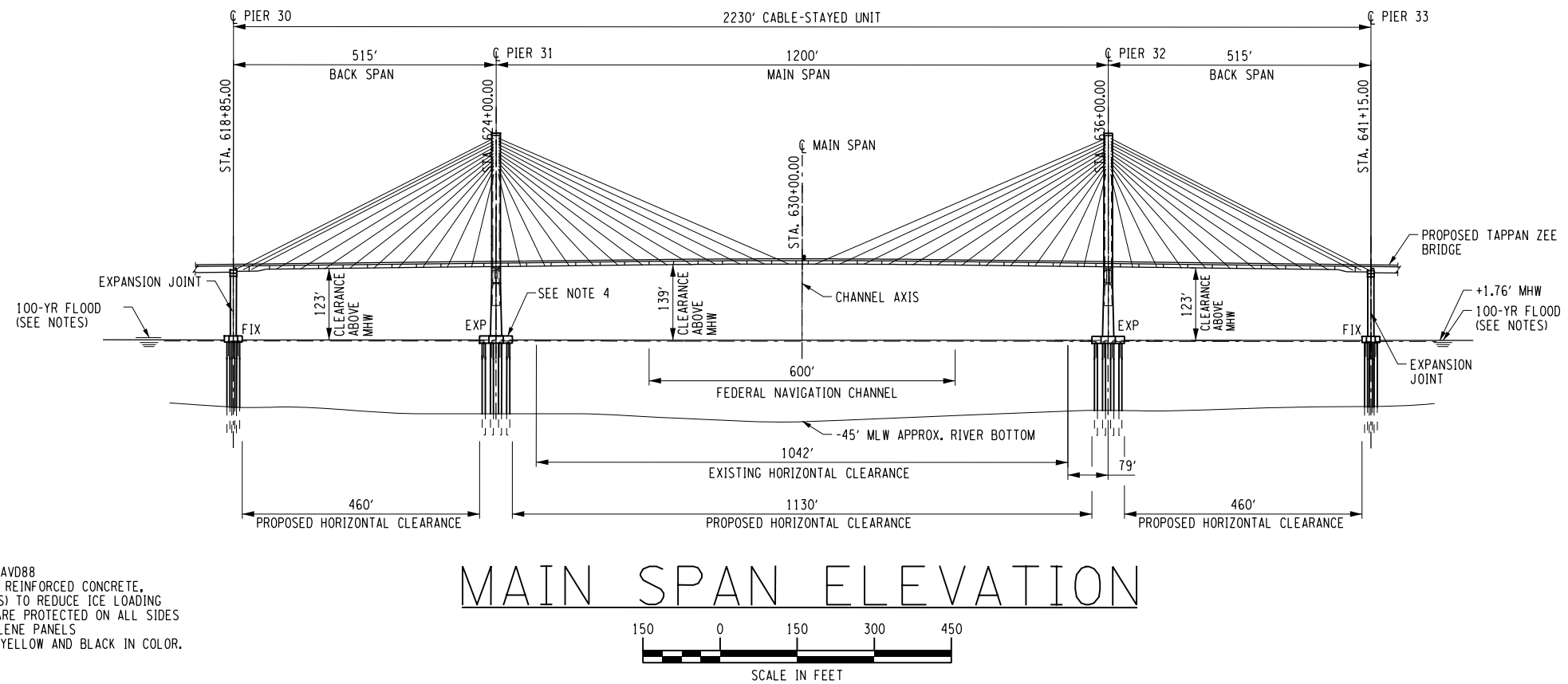
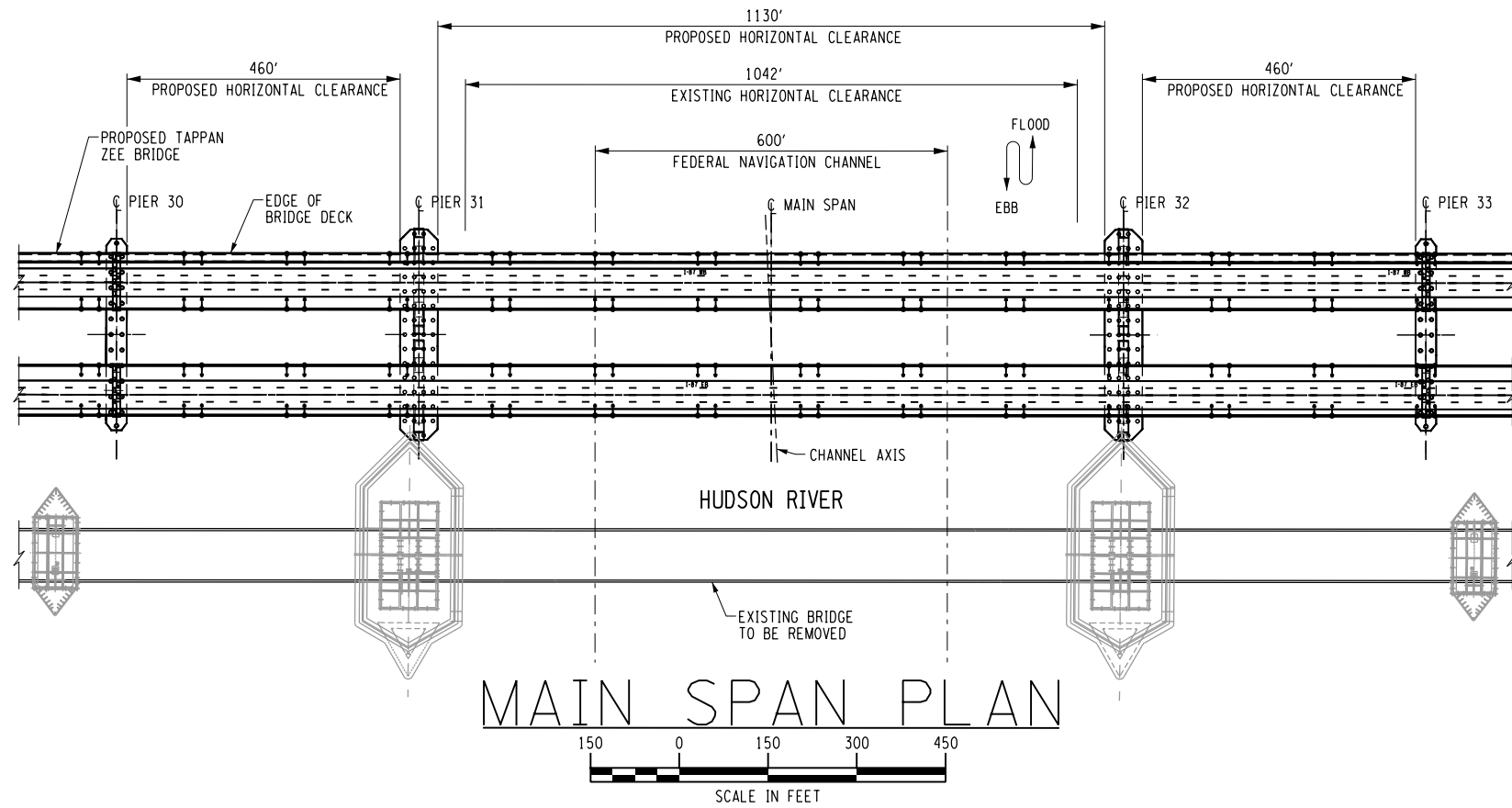

- NOTES:
 1. FEMA MAP 100-YEAR FLOOD ELEVATION EL. 7' NAVD88
 2. MAIN SPAN ANCHOR PIERS ARE CONSTRUCTED OF REINFORCED CONCRETE, HAVE THREE SIDED NOSES (NORTH & SOUTH ENDS) TO REDUCE ICE LOADING AND PROVIDE VESSEL IMPACT PROTECTION AND ARE PROTECTED ON ALL SIDES WITH ULTRA HIGH MOLECULAR WEIGHT POLYETHYLENE PANELS (2" THICK x 11' HIGH x 4' WIDE) ALTERNATING YELLOW AND BLACK IN COLOR.



SIGNATURE _____ DATE _____

TAPPAN ZEE BRIDGE
 HUDSON RIVER, MILEPOINT 27
 SOUTH NYACK-TARRYTOWN, NEW YORK
 ROCKLAND AND WESTCHESTER COUNTIES

ALL DIMENSIONS IN FT UNLESS OTHERWISE NOTED

CONTRACT NUMBER
 D214134
 MAIN SPAN PLAN AND ELEVATION
 SHEET NO. 3 OF 15

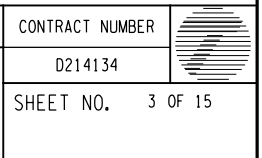

FILE NAME : c:\pwworking\pitt\0704876\JPA-004.dgn
 DATE/TIME : 12-27-2012 5:27:11 PM
 USER : hshn

PROJECT MANAGER

CHECK

DRAFTING

CHECK

DESIGN

JOB MANAGER

DESIGN SUPERVISOR

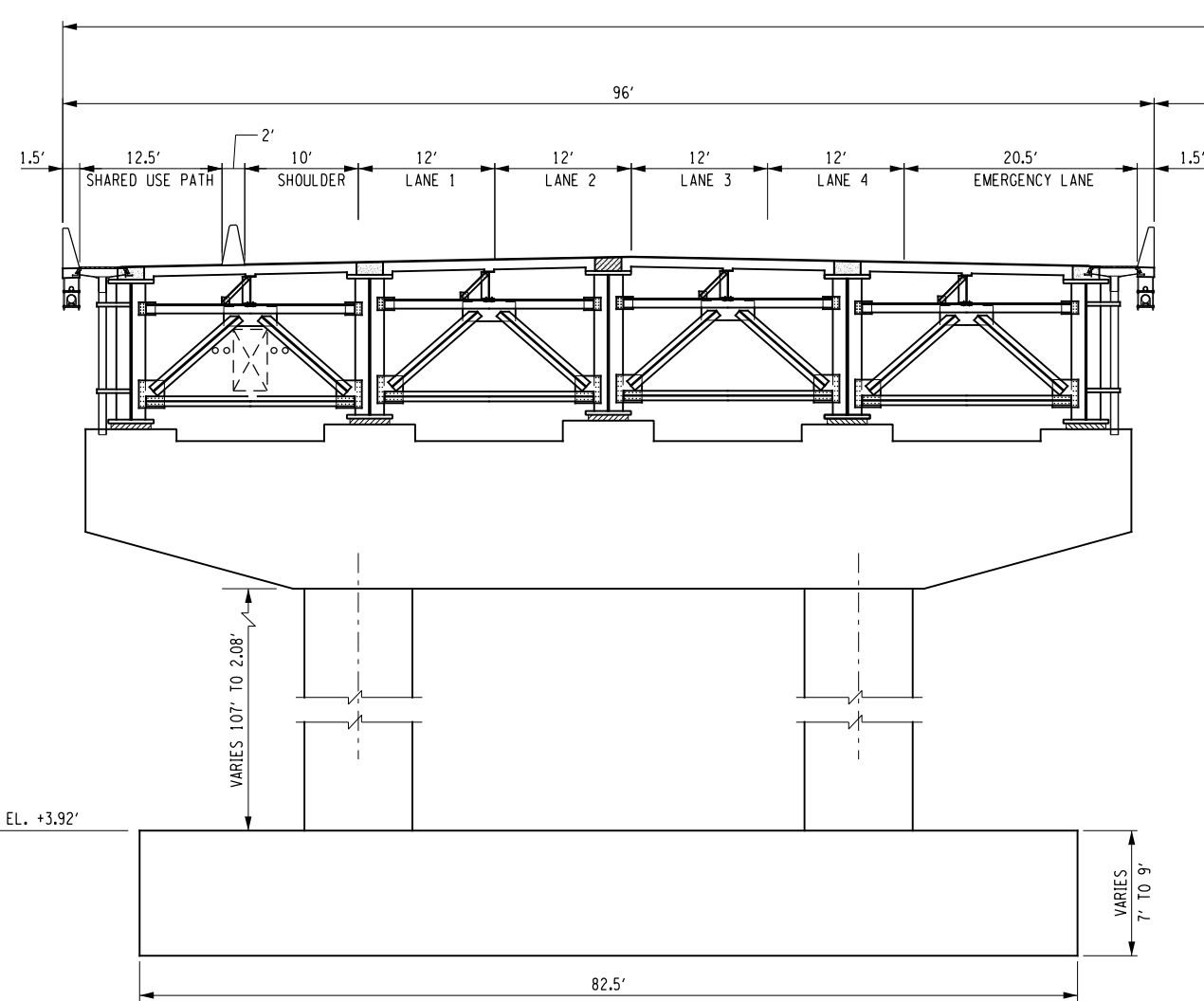

WESTBOUND

VARIES FROM 219' TO 279'

VARIES FROM 36' TO 96'

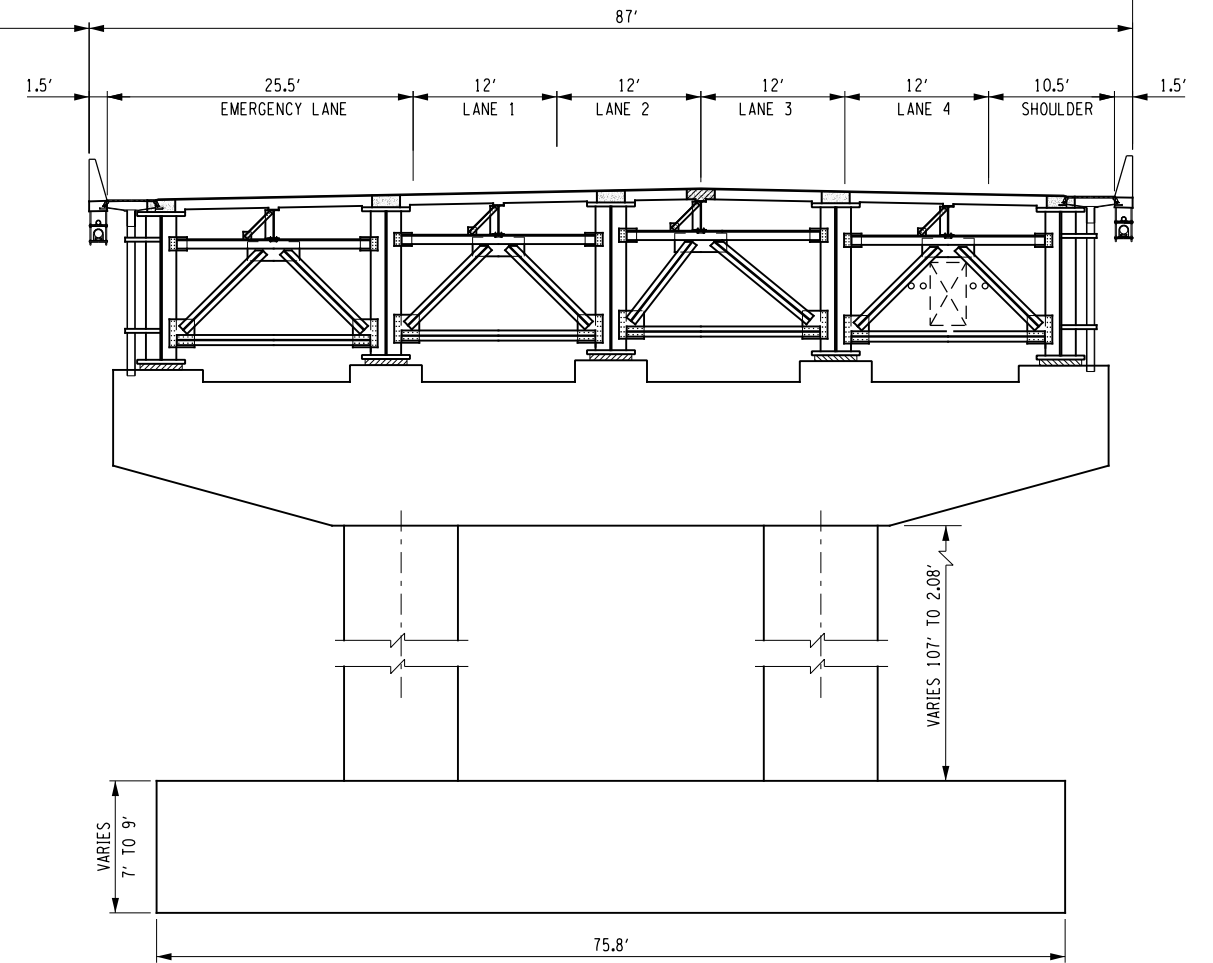

EASTBOUND

TYPICAL APPROACH ROADWAY SECTION

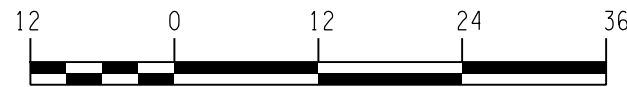

SCALE IN FEET



SIGNATURE _____ DATE _____

TAPPAN ZEE BRIDGE
 HUDSON RIVER, MILEPOINT 27
 SOUTH NYACK-TARRYTOWN, NEW YORK
 ROCKLAND AND WESTCHESTER COUNTIES

TYPICAL ROADWAY SECTION	ALL DIMENSIONS IN FT UNLESS OTHERWISE NOTED	CONTRACT NUMBER D214134
		SHEET NO. 4 OF 15

NEW YORK STATE DEPARTMENT OF TRANSPORTATION REGION
 DOCUMENT NAME:

FILE NAME = c:\pwworking\pitt\0704876\JPA-005.dgn
 DATE/TIME = 12-27-2012 5:27:15 PM
 USER = hshin

DESIGN SUPERVISOR
 JOB MANAGER
 DESIGN
 DRAFTING
 CHECK
 CHECK
 PROJECT MANAGER

NOTES:

1. MAIN SPAN ROADWAY AND SHOULDER DIMENSIONS ARE THE SAME DIMENSIONS AS SHOWN ON SHEET 4, TYPICAL APPROACH ROADWAY SECTIONS.

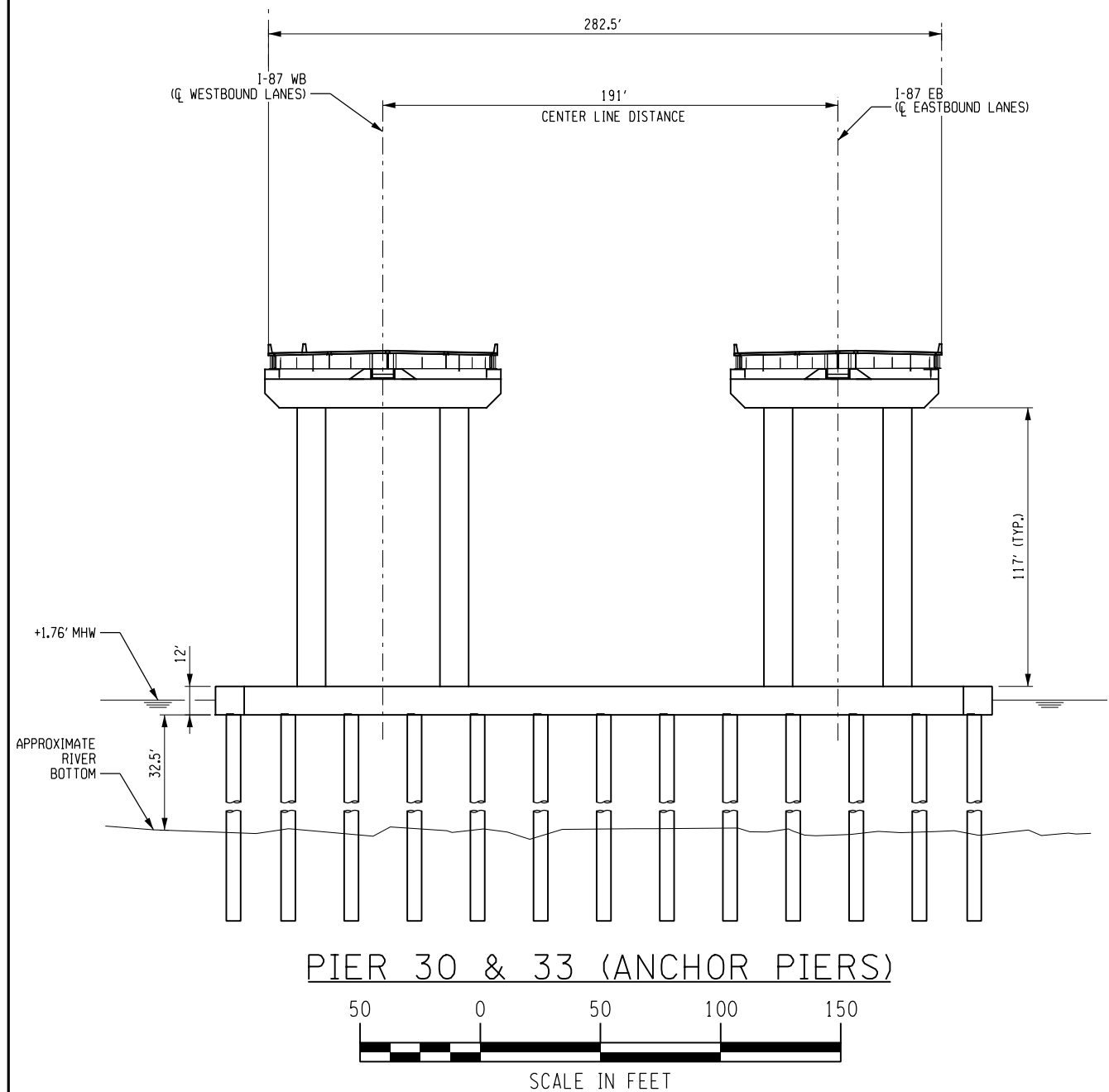

PIER 30 & 33 (ANCHOR PIERS)

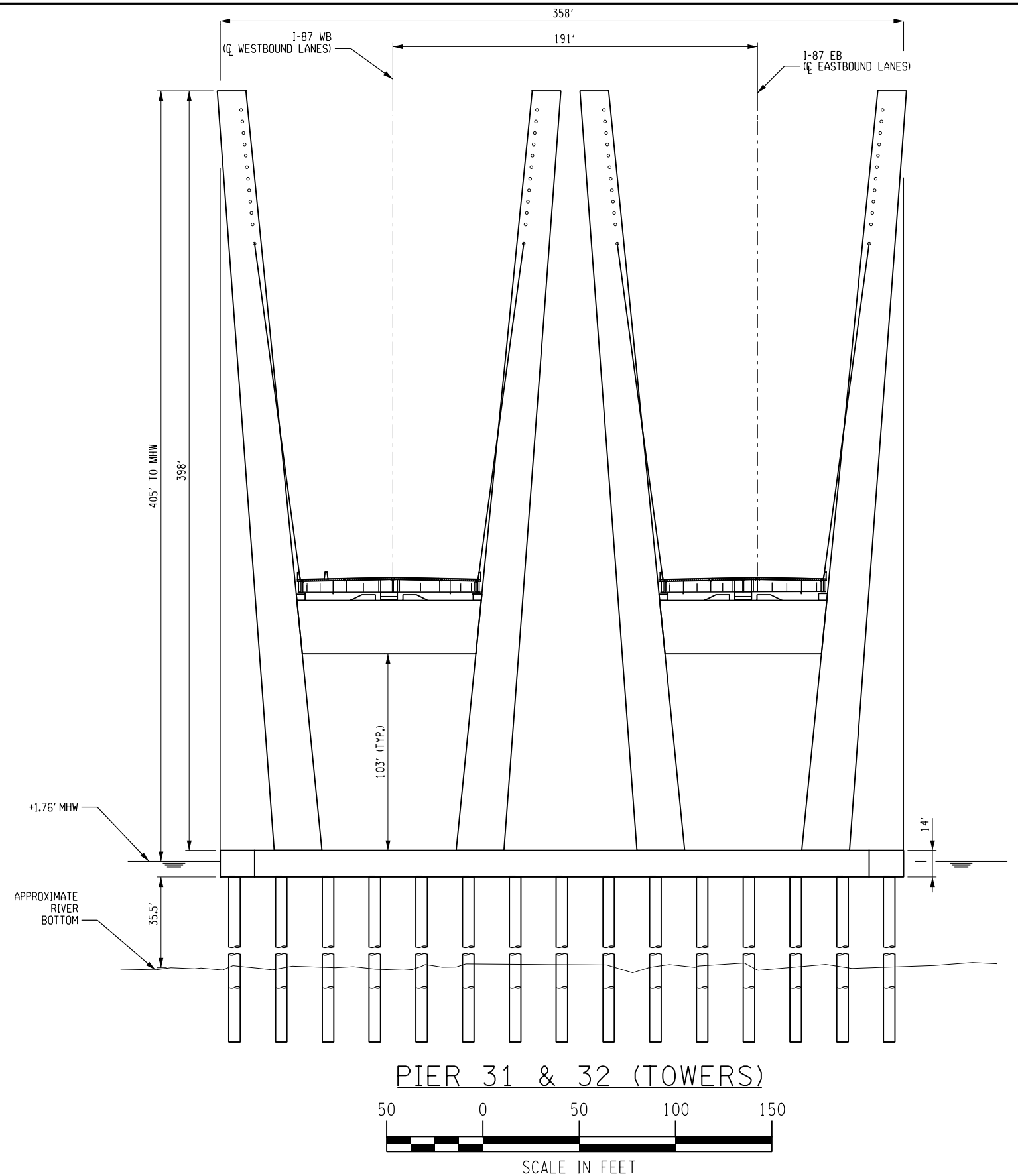
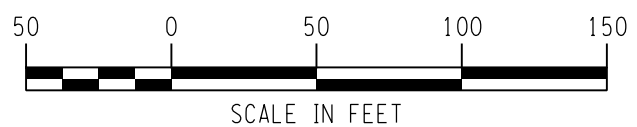

PIER 31 & 32 (TOWERS)

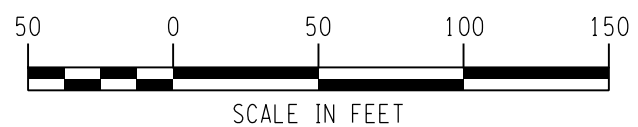

SIGNATURE _____ DATE _____

TAPPAN ZEE BRIDGE
 HUDSON RIVER, MILEPOINT 27
 SOUTH NYACK-TARRYTOWN, NEW YORK
 ROCKLAND AND WESTCHESTER COUNTIES

ALL DIMENSIONS IN FT UNLESS OTHERWISE NOTED
 ANCHOR PIERS AND TOWER SECTION

CONTRACT NUMBER
 D214134
 SHEET NO. 5 OF 15

FILE NAME : c:\pwworking\pitt\0704876\JPA-006.dgn
 DATE/TIME : 12-27-2012 5:27:27 PM
 USER : hshin

DESIGN SUPERVISOR _____ JOB MANAGER _____ DESIGN _____ CHECK _____ DRAFTING _____ CHECK _____ PROJECT MANAGER _____

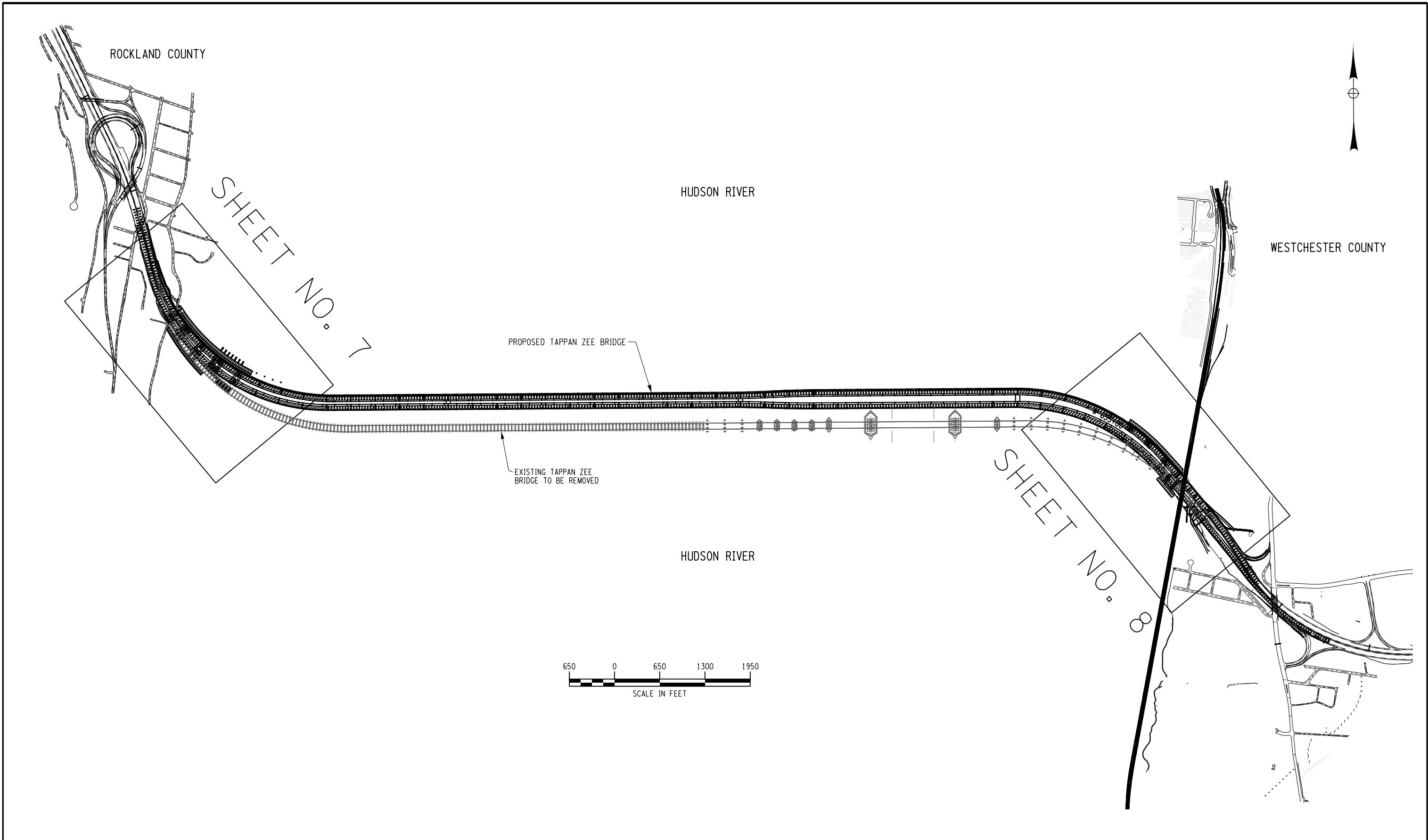

SIGNATURE _____ DATE _____

TAPPAN ZEE BRIDGE
 HUDSON RIVER, MILEPOINT 27
 SOUTH NYACK-TARRYTOWN, NEW YORK
 ROCKLAND AND WESTCHESTER COUNTIES

ALL DIMENSIONS IN FT UNLESS OTHERWISE NOTED

LANDING OVERALL PLAN VIEW

CONTRACT NUMBER
 D214134
 SHEET NO. 6 OF 15

NEW YORK STATE DEPARTMENT OF TRANSPORTATION REGION
 DOCUMENT NAME:

FILE NAME : c:\pwworking\pitt\d0704876\JPA-007.dgn
 DATE/TIME : 01-02-2013 5:00:11 PM
 USER : mdecoc

DESIGN SUPERVISOR
 JOB MANAGER
 DESIGN
 CHECK
 DRAFTING
 CHECK
 PROJECT MANAGER

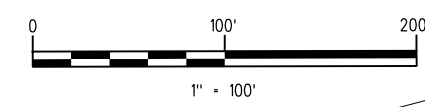
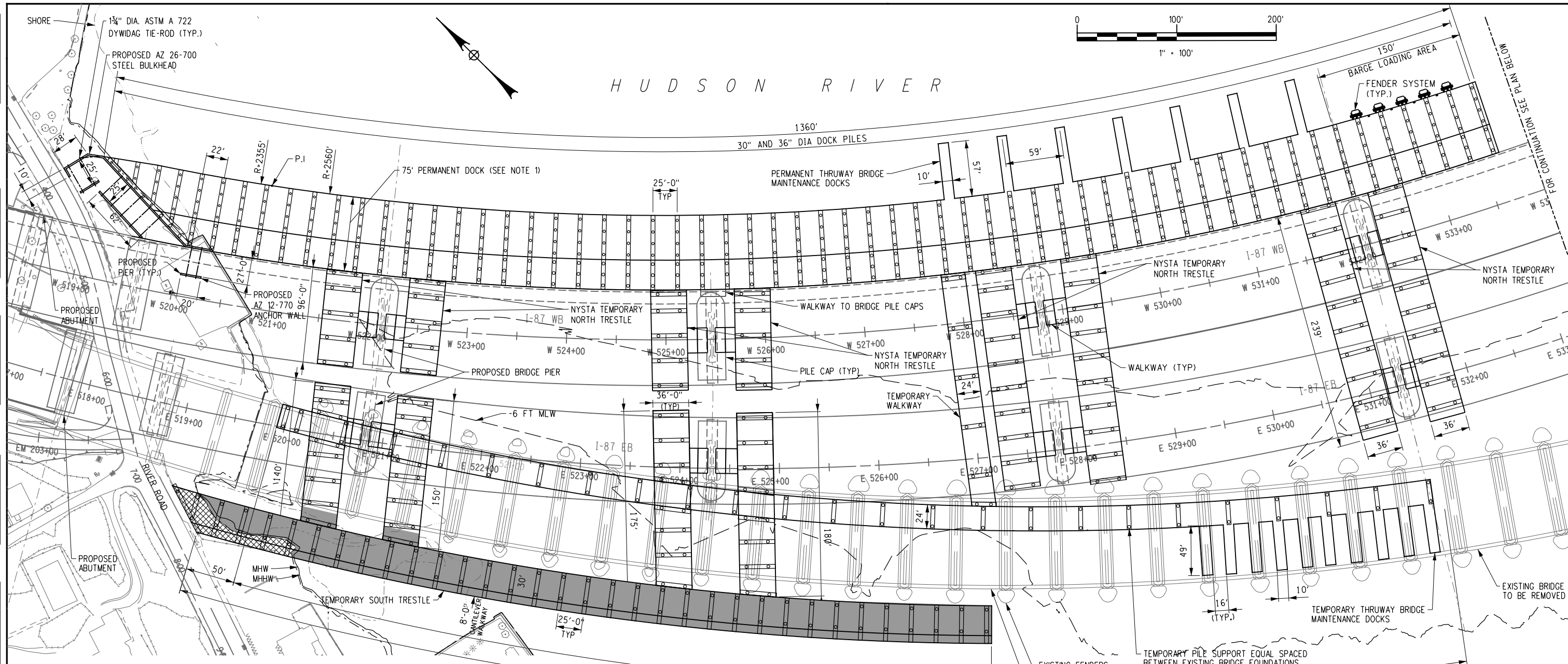

H U D S O N R I V E R

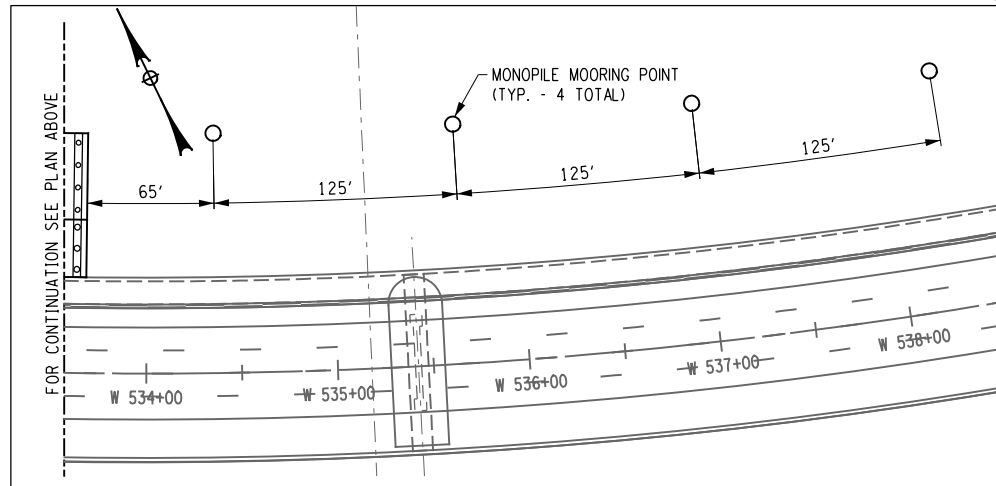

- LEGEND:**
- MHHW = EL. +2.02' (NAVD88)
 - MHW = EL. +1.76' (NAVD88)
 - -6 FT MLW = EL. -7.69' (NAVD88)
 - AREA IN NYSDEC TIDAL WETLANDS
 - ▨ NYSDEC TIDAL WETLANDS ADJACENT AREA

- NOTES:**
1. NYSTA NORTH DOCK TO BE SUPPORTED ON PILES AND CONNECTED TO BRIDGE PIERS.

TOTAL ESTIMATED TRESTLE QUANTITY INFORMATION TABLE					
	DIAMETER PILES			PILE AREA (SQ. FT.)	DECK AREA (SQ. FT.)
	36"	30"	14"		
NYSTA PERMANENT NORTH DOCK	169	235	14"	2,348	106,435
NYSTA TEMPORARY NORTH TRESTLE	120			848	88,440
TEMPORARY WALKWAY	12			85	5,700
TEMPORARY SOUTH TRESTLE	131		50	926	50,000
NYSTA TEMPORARY DOCK				53	35,000

ESTIMATED QUANTITY IN NYSDEC TIDAL WETLANDS					
	DIAMETER PILES			PILE AREA (SQ. FT.)	DECK AREA (SQ. FT.)
	36"	30"	14"		
TEMPORARY SOUTH TRESTLE	64			452	30,500

ESTIMATED QUANTITY IN NYSDEC TIDAL WETLANDS ADJACENT AREA					
	DIAMETER PILES			PILE AREA (SQ. FT.)	DECK AREA (SQ. FT.)
	36"	30"	14"		
TEMPORARY SOUTH TRESTLE	7			49	220

TAPPAN ZEE BRIDGE
 HUDSON RIVER, MILEPOINT 27
 SOUTH NYACK-TARRYTOWN, NEW YORK
 ROCKLAND AND WESTCHESTER COUNTIES

SIGNATURE _____
 DATE _____

ALL DIMENSIONS IN FT UNLESS OTHERWISE NOTED
 CONTRACT NUMBER: D214134
 SHEET NO. 7 OF 15

FILE NAME = c:\pwworking\pitt\0704876\JPA-008.dgn
 DATE/TIME = 12-27-2012 5:27:43 PM
 USER = hshn

DESIGN SUPERVISOR JOB MANAGER DESIGN CHECK DRAFTING CHECK PROJECT MANAGER

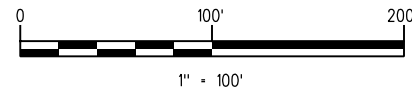

H U D S O N R I V E R

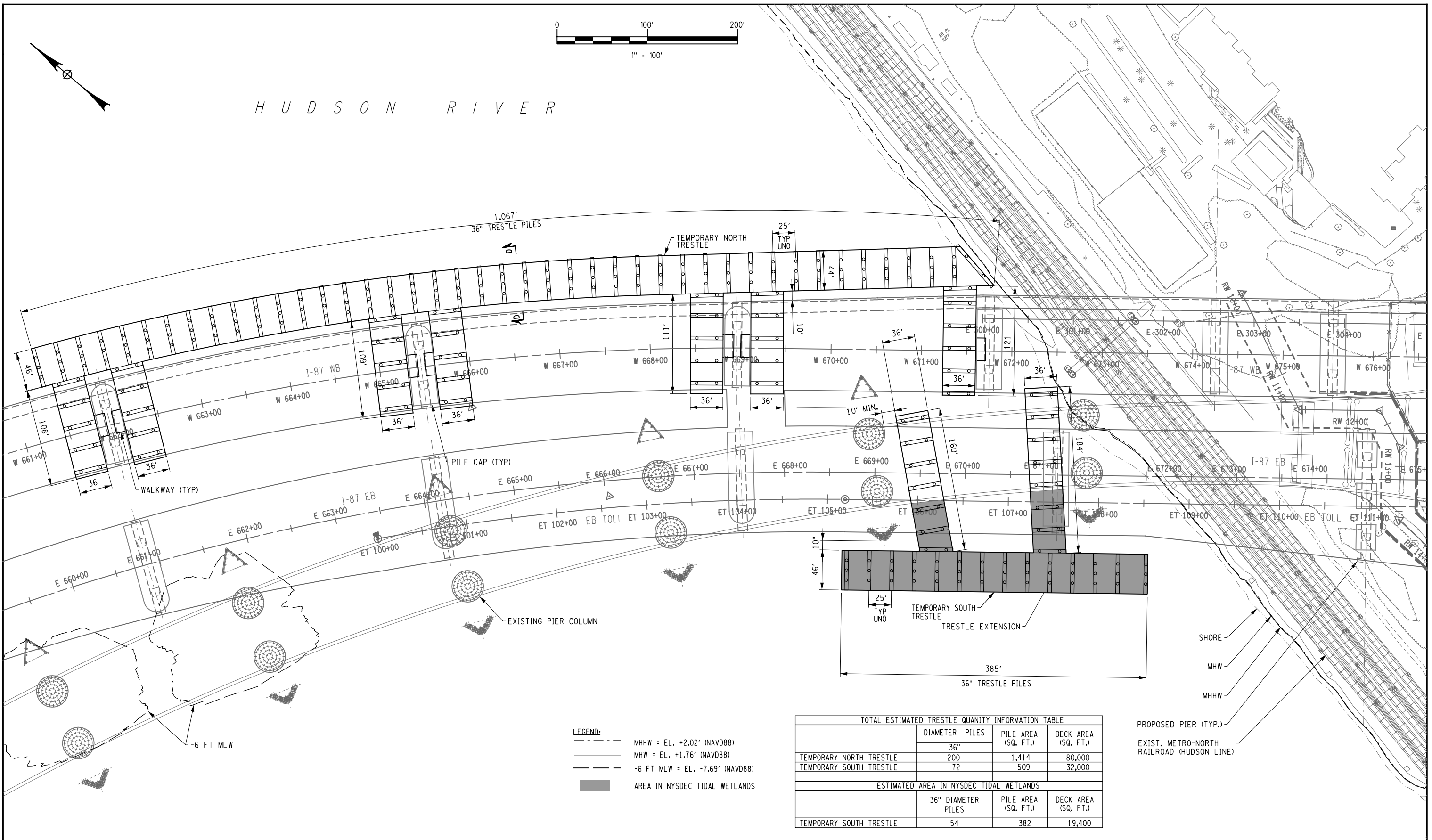

- LEGEND:**
- MHHW = EL. +2.02' (NAVD88)
 - MHW = EL. +1.76' (NAVD88)
 - -6 FT MLW = EL. -7.69' (NAVD88)
 - AREA IN NYSDEC TIDAL WETLANDS

TOTAL ESTIMATED TRESTLE QUANTITY INFORMATION TABLE			
	DIAMETER	PILES	PILE AREA (SQ. FT.)
TEMPORARY NORTH TRESTLE	36"	200	1,414
TEMPORARY SOUTH TRESTLE	36"	72	509
ESTIMATED AREA IN NYSDEC TIDAL WETLANDS			
	36" DIAMETER PILES	PILE AREA (SQ. FT.)	DECK AREA (SQ. FT.)
TEMPORARY SOUTH TRESTLE	54	382	19,400



SIGNATURE _____ DATE _____

TAPPAN ZEE BRIDGE
 HUDSON RIVER, MILEPOINT 27
 SOUTH NYACK-TARRYTOWN, NEW YORK
 ROCKLAND AND WESTCHESTER COUNTIES

ALL DIMENSIONS IN FT UNLESS OTHERWISE NOTED

WESTCHESTER COUNTY LANDING

CONTRACT NUMBER
 D214134
 SHEET NO. 8 OF 15

FILE NAME : c:\pwworking\pitt\0704876\JPA-009.dgn
 DATE/TIME : 12-27-2012 5:27:49 PM
 USER : hshn

PROJECT MANAGER

CHECK

DRAFTING

CHECK

DESIGN

JOB MANAGER

DESIGN SUPERVISOR

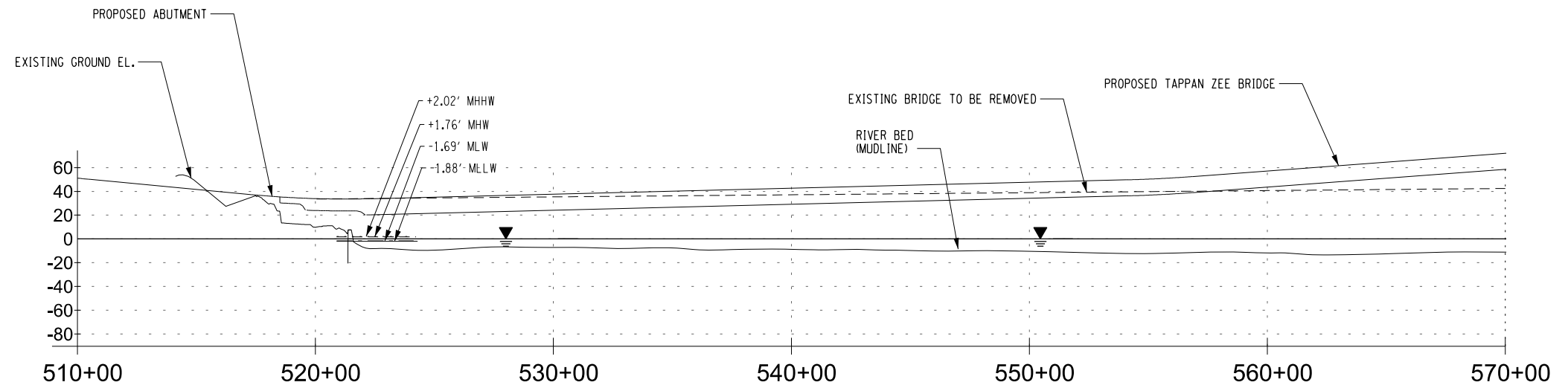

ROCKLAND COUNTY SECTION

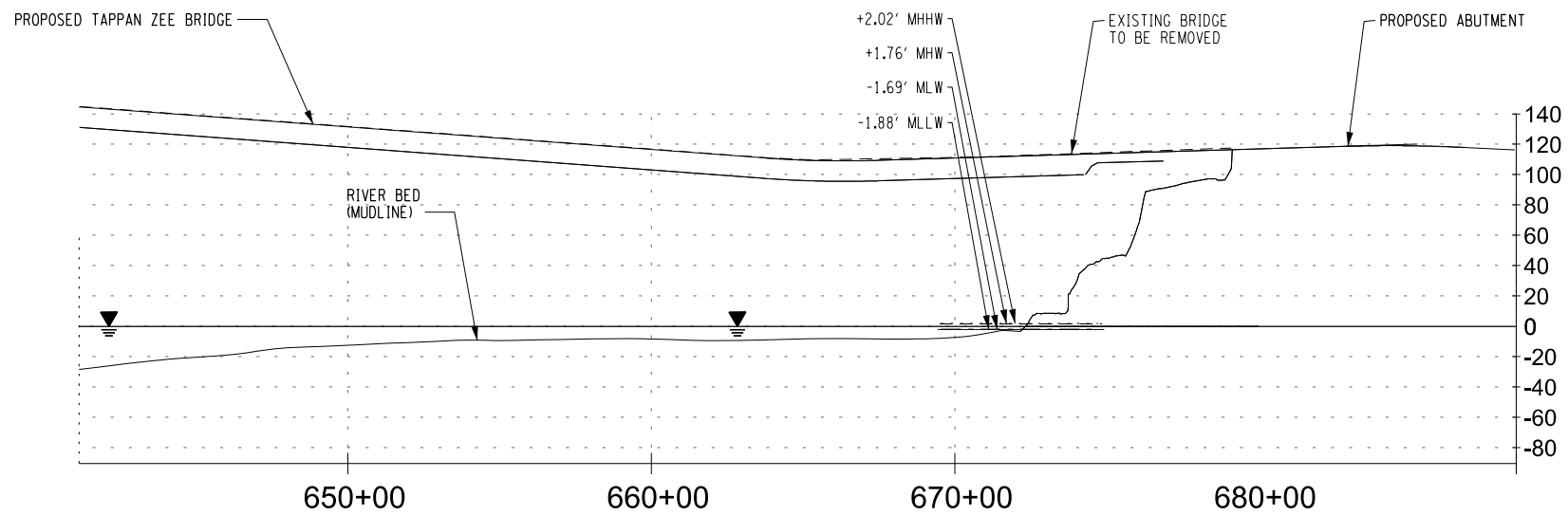

WESTCHESTER COUNTY SECTION



A Consortium of Fluor, American Bridge, Granite, and Traylor Bros.

SIGNATURE _____ DATE _____

TAPPAN ZEE BRIDGE
 HUDSON RIVER, MILEPOINT 27
 SOUTH NYACK-TARRYTOWN, NEW YORK
 ROCKLAND AND WESTCHESTER COUNTIES

ALL DIMENSIONS IN FT UNLESS OTHERWISE NOTED	CONTRACT NUMBER
ROCKLAND AND WESTCHESTER COUNTY CROSS SECTIONS	D214134
	SHEET NO. 9 OF 15

NEW YORK STATE DEPARTMENT OF TRANSPORTATION REGION
 DOCUMENT NAME:

FILE NAME : c:\pwworking\pitt\0704876\JPA-010.dgn
 DATE/TIME : 01-02-2013 4:33:08 PM
 USER : mdecoco

DESIGN SUPERVISOR
 DESIGN
 CHECK
 DRAFTING
 CHECK
 PROJECT MANAGER

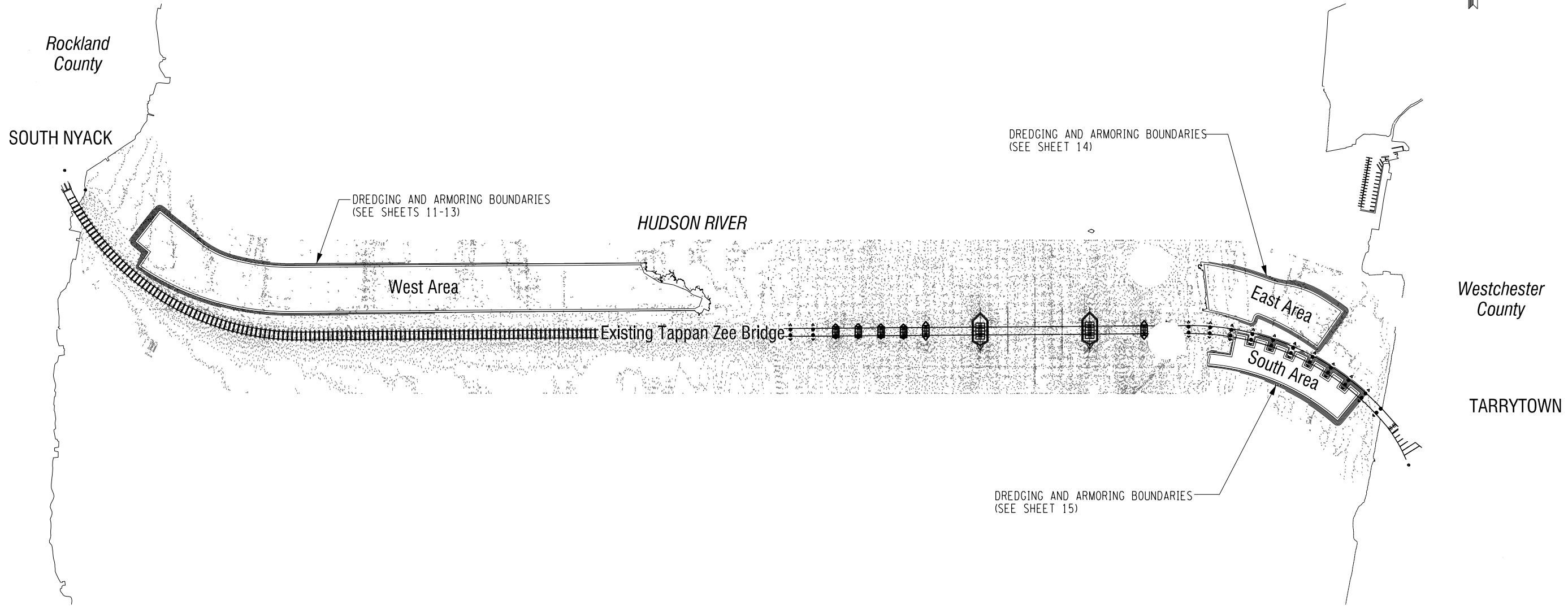

NOTES:

1. BASED UPON S.T. HUDSON ENGINEERS, INC. HYDROGRAPHIC SURVEY DATED JANUARY 26, 2012, SIGNED BY MR. MARK KLEIN #182 AND SIGNED AND SEALED BY MR. MICHAEL FASNACHT, NYSPE #57352.
2. AREAS IN TABLE BASED ON TOP OF SLOPE OF ACCESS CHANNEL AND ARMORING ELEVATION.

DREDGING	DEPTH AT MEAN LOWER LOW WATER (MLLW)	WEST AREA		EAST AREA		SOUTH AREA		TOTAL AREA (AC.)	TOTAL VOLUME (MCY)
		SCHEDULED DATES: AUG-OCT 2013		SCHEDULED DATES: AUG-OCT 2013		SCHEDULED DATES: AUG-OCT 2014			
		SURFACE AREA (AC.)	VOLUME (MCY)	SURFACE AREA (AC.)	VOLUME (MCY)	SURFACE AREA (AC.)	VOLUME (MCY)		
ACCESS CHANNEL	-13.0	95.3	0.52	24.1	0.16	19.1	0.13	138.5	0.81
OVERDEPTH ALLOWANCE (1FT)	-14.0		0.10		0.02		0.02		0.14
DREDGING TOTAL			0.62		0.18		0.15	138.5	0.95
ARMORING	-11.0	76.1	0.25	17.1	0.06	13.3	0.05	106.5	0.36

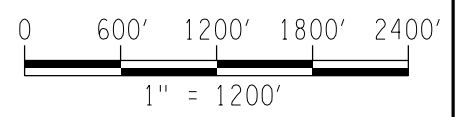

		TAPPAN ZEE BRIDGE HUDSON RIVER, MILEPOINT 27 SOUTH NYACK-TARRYTOWN, NEW YORK ROCKLAND AND WESTCHESTER COUNTIES	ALL DIMENSIONS IN FT UNLESS OTHERWISE NOTED PROPOSED TEMPORARY ACCESS CHANNEL DREDGING PLAN TO -13'	CONTRACT NUMBER D214134 SHEET NO. 10 OF 15	
SIGNATURE _____	DATE _____				

FILE NAME : c:\pwworking\pitt\0704876\JPA-011.dgn
 DATE/TIME : 12-27-2012 5:28:23 PM
 USER : hshn

DESIGN SUPERVISOR
 JOB MANAGER
 DESIGN
 CHECK
 DRAFTING
 CHECK
 PROJECT MANAGER

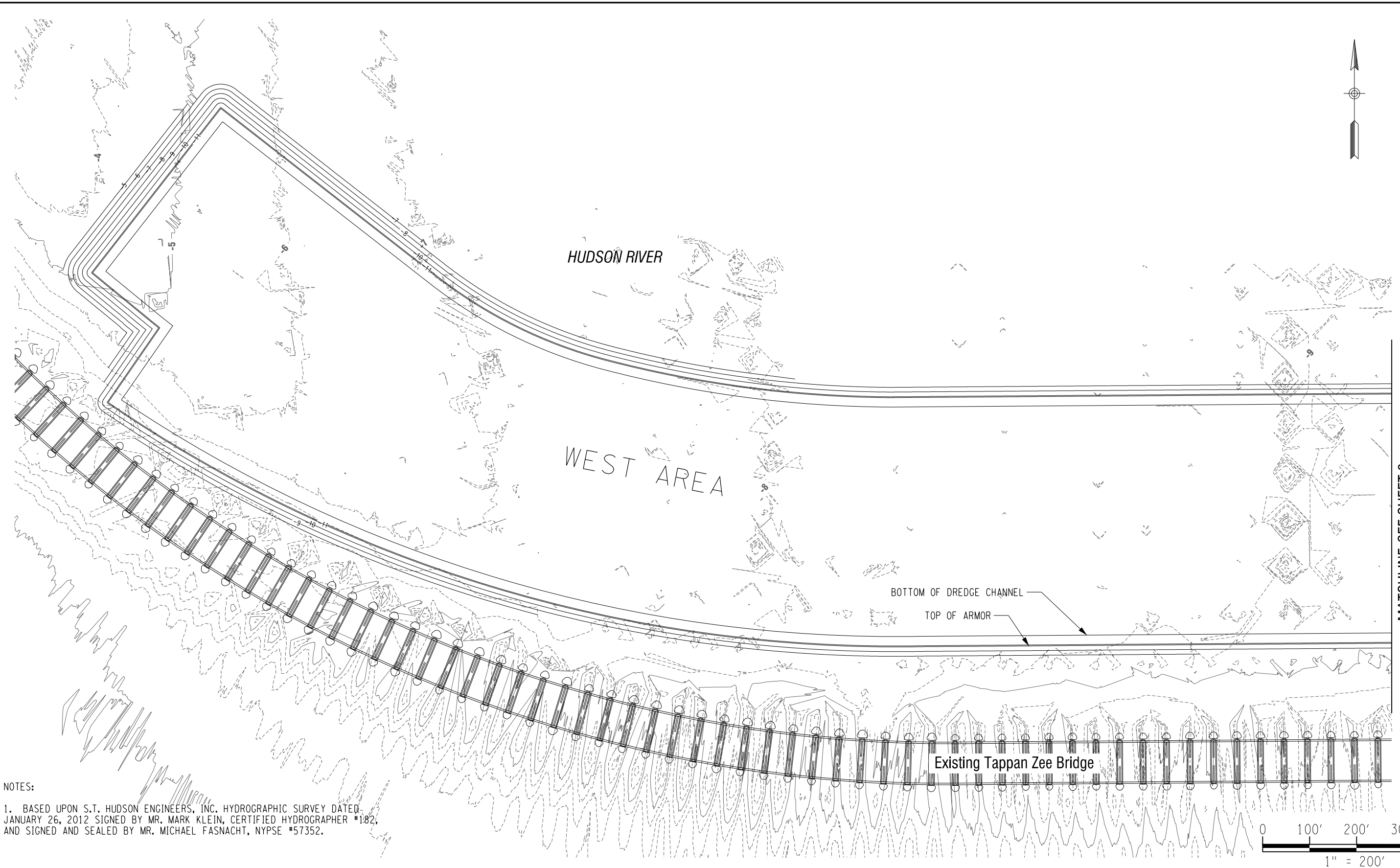

NOTES:

1. BASED UPON S.T. HUDSON ENGINEERS, INC. HYDROGRAPHIC SURVEY DATED JANUARY 26, 2012 SIGNED BY MR. MARK KLEIN, CERTIFIED HYDROGRAPHER #182, AND SIGNED AND SEALED BY MR. MICHAEL FASNACHT, NYPSE #57352.



A Consortium of Fluor, American Bridge, Granite, and Traylor Bros.

SIGNATURE _____ DATE _____

TAPPAN ZEE BRIDGE
 HUDSON RIVER, MILEPOINT 27
 SOUTH NYACK-TARRYTOWN, NEW YORK
 ROCKLAND AND WESTCHESTER COUNTIES

ALL DIMENSIONS IN FT UNLESS OTHERWISE NOTED

PROPOSED TEMPORARY ACCESS
 CHANNEL DREDGING PLAN - WEST AREA
 (STAGE 1)

CONTRACT NUMBER
 D214134
 SHEET NO. 11 OF 15

NEW YORK STATE DEPARTMENT OF TRANSPORTATION REGION
 DOCUMENT NAME:

FILE NAME : c:\pwworking\pitt\0704876\JPA-012.dgn
 DATE/TIME : 12-27-2012 5:28:30 PM
 USER : hshn

DESIGN SUPERVISOR JOB MANAGER DESIGN CHECK DRAFTING CHECK PROJECT MANAGER

MATCHLINE-SEE SHEET 2

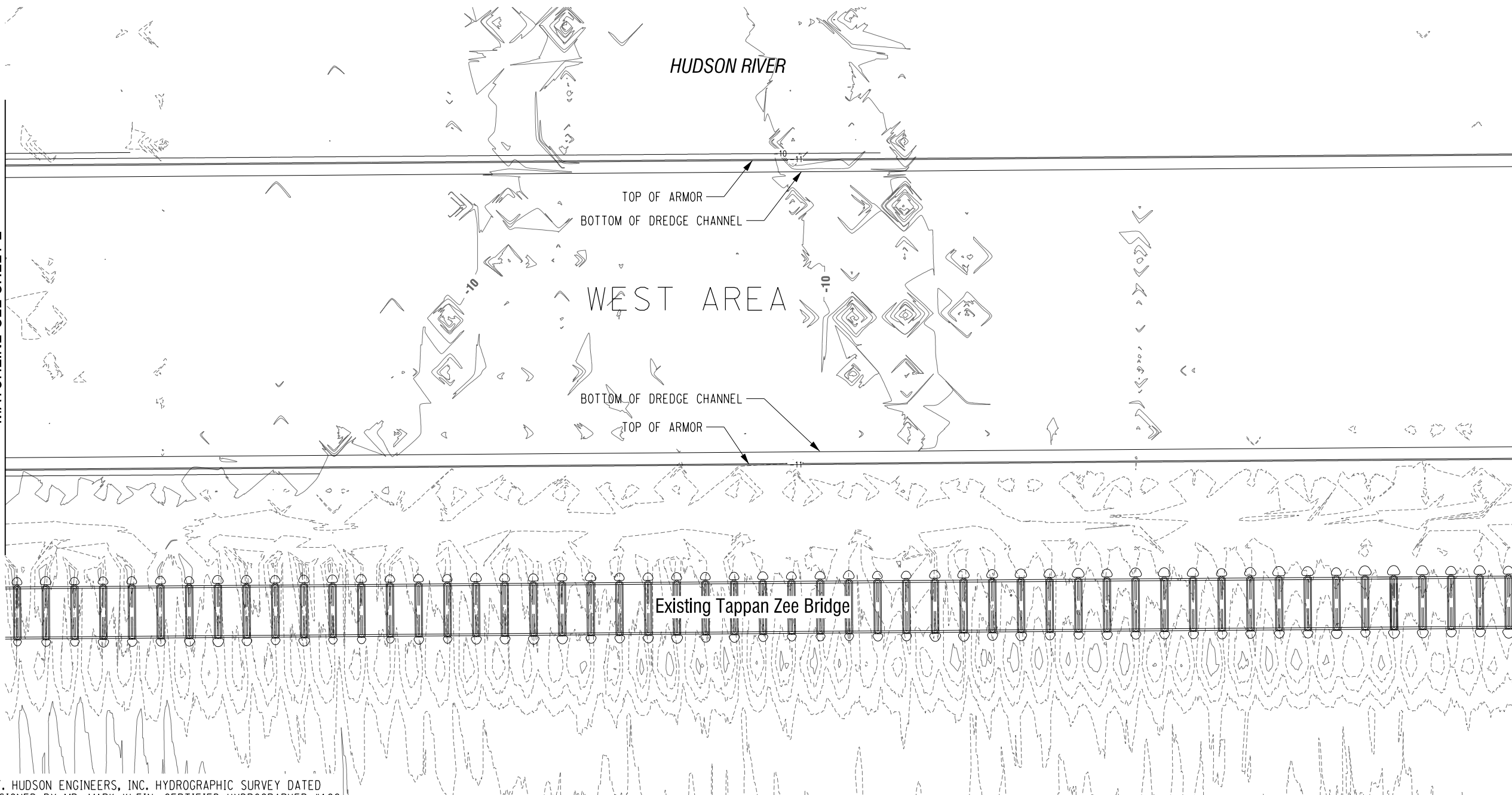

NOTES:

1. BASED UPON S.T. HUDSON ENGINEERS, INC. HYDROGRAPHIC SURVEY DATED JANUARY 26, 2012 SIGNED BY MR. MARK KLEIN, CERTIFIED HYDROGRAPHER #182, AND SIGNED AND SEALED BY MR. MICHAEL FASNACHT, NYPSE #57352.

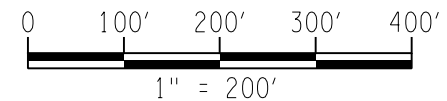

MATCHLINE-SEE SHEET 4



SIGNATURE _____ DATE _____

TAPPAN ZEE BRIDGE
 HUDSON RIVER, MILEPOINT 27
 SOUTH NYACK-TARRYTOWN, NEW YORK
 ROCKLAND AND WESTCHESTER COUNTIES

ALL DIMENSIONS IN FT UNLESS OTHERWISE NOTED
 PROPOSED TEMPORARY ACCESS
 CHANNEL DREDGING PLAN - WEST AREA
 (STAGE 1)

CONTRACT NUMBER
 D214134
 SHEET NO. 12 OF 15

FILE NAME : c:\pwworking\pitt\0704876\JPA-013.dgn
 DATE/TIME : 12-27-2012 5:28:38 PM
 USER : hshn

DESIGN SUPERVISOR
 JOB MANAGER
 DESIGN
 CHECK
 DRAFTING
 CHECK
 PROJECT MANAGER

MATCHLINE-SEE SHEET 3

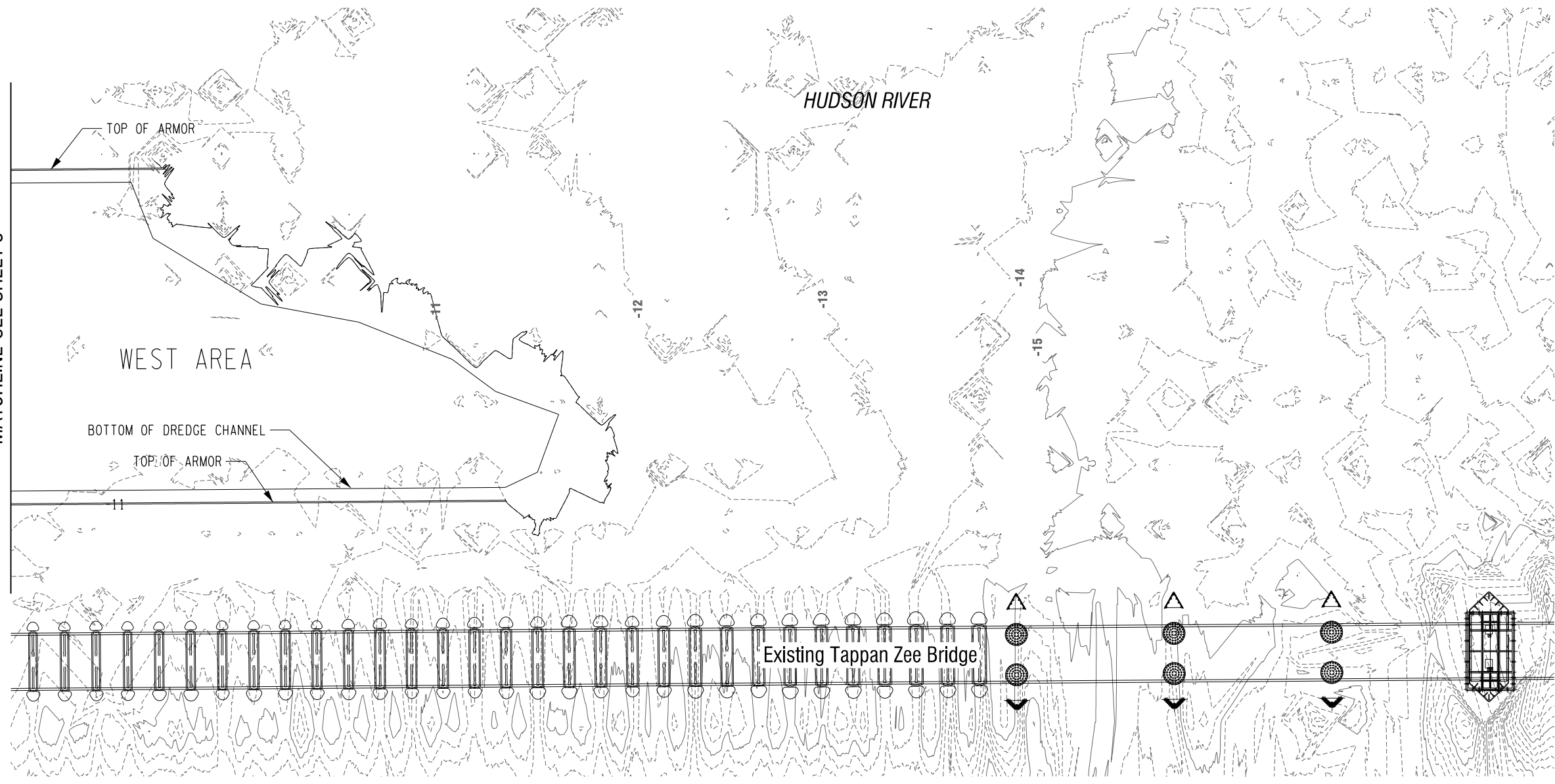

NOTES:
 1. BASED UPON S.T. HUDSON ENGINEERS, INC. HYDROGRAPHIC SURVEY DATED JANUARY 26, 2012 SIGNED BY MR. MARK KLEIN, CERTIFIED HYDROGRAPHER #182, AND SIGNED AND SEALED BY MR. MICHAEL FASNACHT, NYPSE #57352.

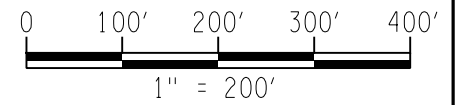

SIGNATURE _____ DATE _____

TAPPAN ZEE BRIDGE
 HUDSON RIVER, MILEPOINT 27
 SOUTH NYACK-TARRYTOWN, NEW YORK
 ROCKLAND AND WESTCHESTER COUNTIES

ALL DIMENSIONS IN FT UNLESS OTHERWISE NOTED

PROPOSED TEMPORARY ACCESS
 CHANNEL DREDGING PLAN - WEST AREA
 (STAGE 1)

CONTRACT NUMBER
 D214134
 SHEET NO. 13 OF 15

NEW YORK STATE DEPARTMENT OF TRANSPORTATION REGION
 DOCUMENT NAME:

FILE NAME : c:\pwworking\pitt\0704876\JPA-014.dgn
 DATE/TIME : 12-27-2012 5:28:45 PM
 USER : hshn

DESIGN SUPERVISOR
 JOB MANAGER
 DESIGN
 CHECK
 DRAFTING
 CHECK
 PROJECT MANAGER

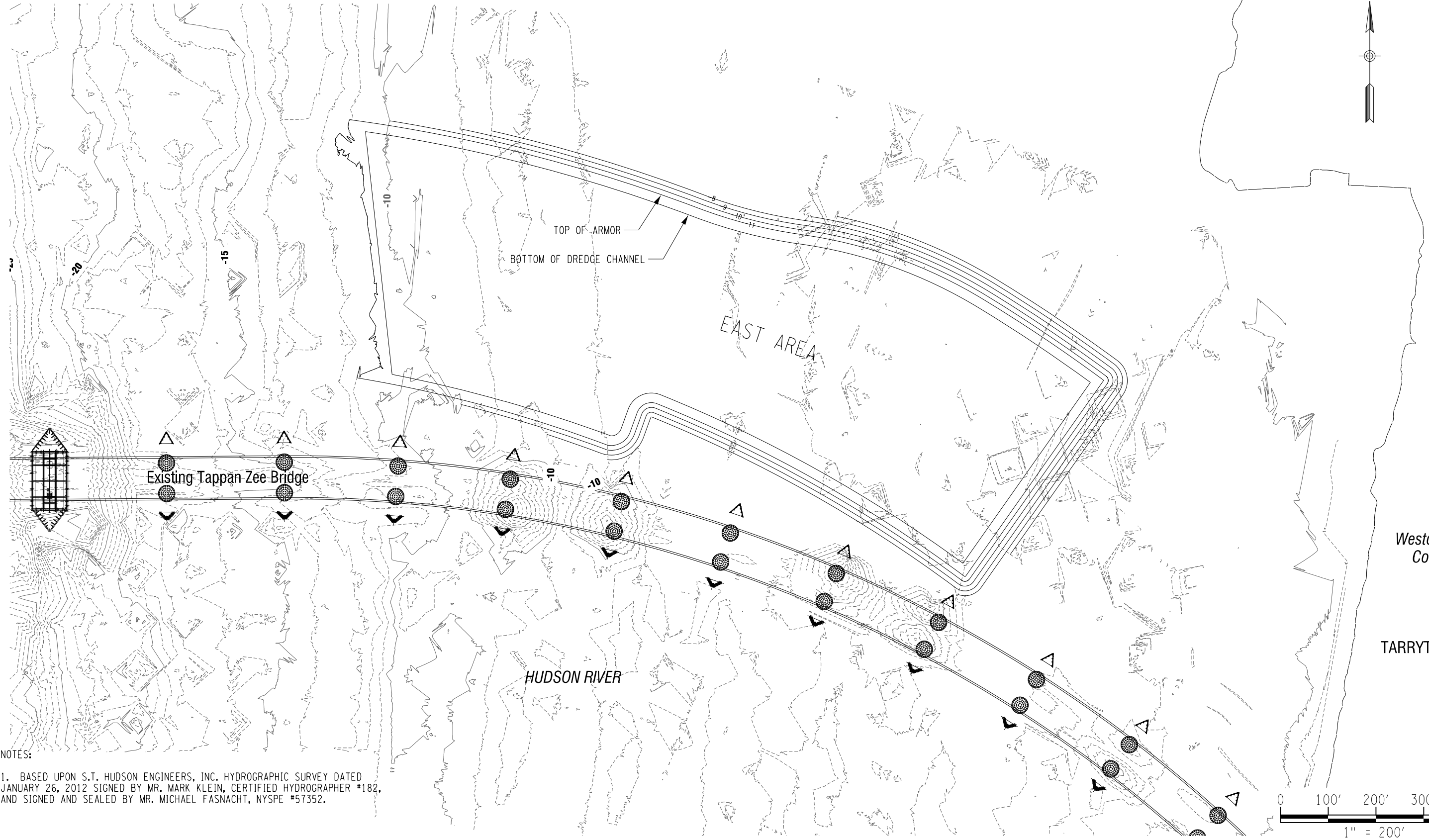

NOTES:
 1. BASED UPON S.T. HUDSON ENGINEERS, INC. HYDROGRAPHIC SURVEY DATED JANUARY 26, 2012 SIGNED BY MR. MARK KLEIN, CERTIFIED HYDROGRAPHER #182, AND SIGNED AND SEALED BY MR. MICHAEL FASNACHT, NYSPE #57352.

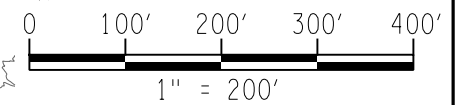

SIGNATURE _____ DATE _____

TAPPAN ZEE BRIDGE
 HUDSON RIVER, MILEPOINT 27
 SOUTH NYACK-TARRYTOWN, NEW YORK
 ROCKLAND AND WESTCHESTER COUNTIES

ALL DIMENSIONS IN FT UNLESS OTHERWISE NOTED

PROPOSED TEMPORARY ACCESS
 CHANNEL DREDGING PLAN - EAST AREA
 (STAGE 1)

CONTRACT NUMBER
 D214134
 SHEET NO. 14 OF 15

NEW YORK STATE DEPARTMENT OF TRANSPORTATION REGION
 DOCUMENT NAME:

FILE NAME : c:\pwworking\pitt\0704876\JPA-015.dgn
 DATE/TIME : 12-27-2012 5:28:55 PM
 USER : hshn

DESIGN SUPERVISOR
 DESIGN
 CHECK
 DRAFTING
 CHECK
 PROJECT MANAGER

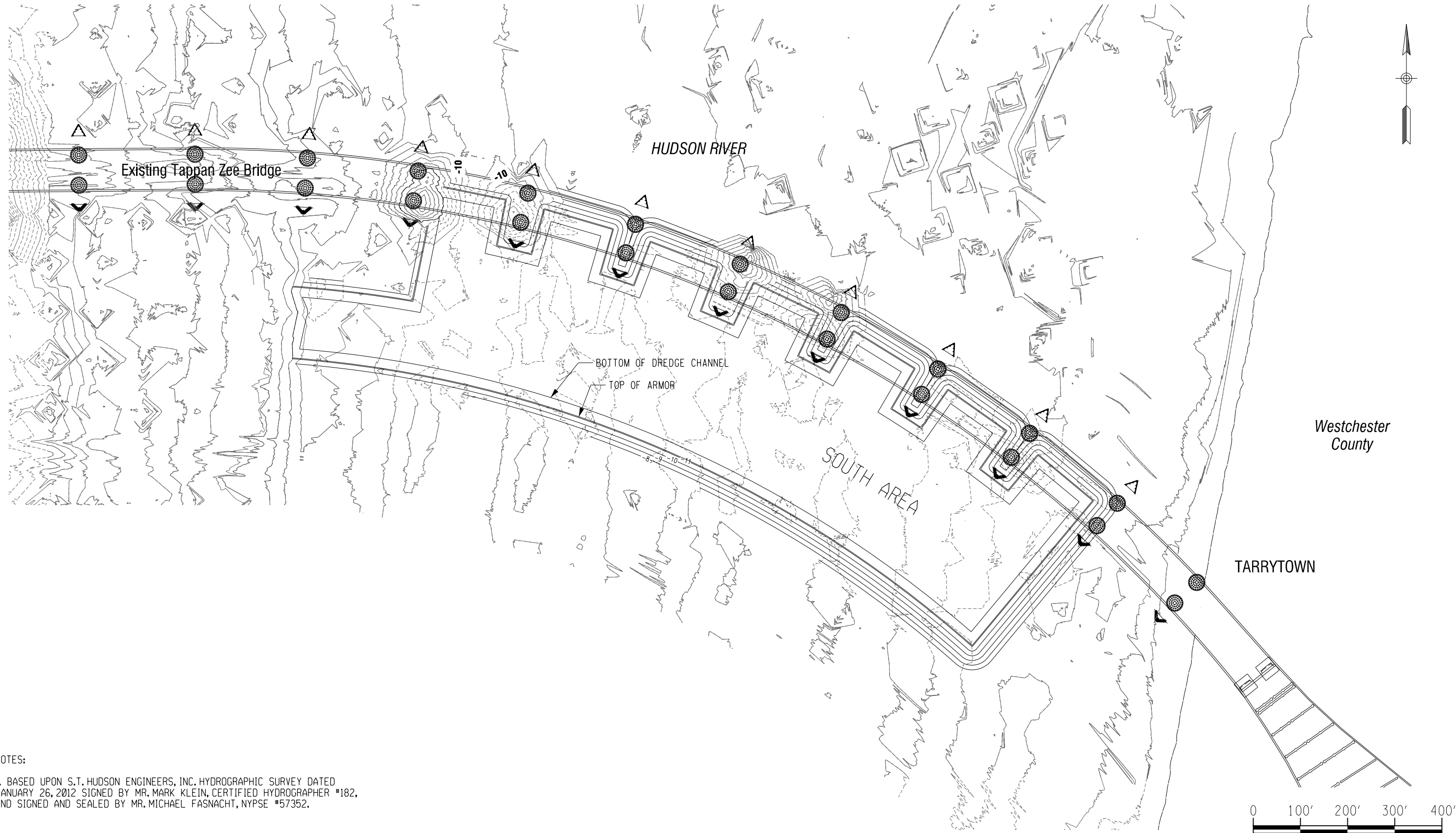

NOTES:
 1. BASED UPON S.T. HUDSON ENGINEERS, INC. HYDROGRAPHIC SURVEY DATED JANUARY 26, 2012 SIGNED BY MR. MARK KLEIN, CERTIFIED HYDROGRAPHER #182, AND SIGNED AND SEALED BY MR. MICHAEL FASNACHT, NYPSE #57352.

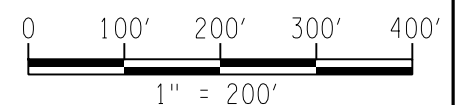

SIGNATURE _____ DATE _____

TAPPAN ZEE BRIDGE
 HUDSON RIVER, MILEPOINT 27
 SOUTH NYACK-TARRYTOWN, NEW YORK
 ROCKLAND AND WESTCHESTER COUNTIES

ALL DIMENSIONS IN FT UNLESS OTHERWISE NOTED

PROPOSED TEMPORARY ACCESS
 CHANNEL DREDGING PLAN - SOUTH AREA
 (STAGE 2)

CONTRACT NUMBER
 D214134
 SHEET NO. 15 OF 15

NEW YORK STATE DEPARTMENT OF TRANSPORTATION REGION
 DOCUMENT NAME:

Attachment 2: Revised Impact Tables

CHANGES IN THE TEMPORARY AND PERMANENT WORK PLATFORMS

Tables 5 and 6 of the Reevaluation Statement have been revised as shown below.

**Table 5
Overwater Coverage from Platforms**

Status	Design Feature	Open Water/ Littoral Zone/ Adjacent Area	FEIS Acreage	Recommended Design Acreage	Net Difference (In acres)
Temporary	WBSA North Platform	Open Water	5.58	1.84	-3.74
	WBSA South Platform	Open Water	N/A	0.29	+0.29
		Littoral Zone	N/A	0.45	+0.45
	WBSA Access Road	Open Water	1.00	N/A	-1.00
		Littoral Zone	0.13	N/A	-0.13
	RBSA Walkway	Open Water	N/A	0.13	+0.13
	RBSA South Platform	Open Water	3.67	0.44	-3.23
		Littoral Zone	0	0.70	+0.70
		Adjacent Area	0	0.005	+0.005
	RBSA Temporary North Platform	Open Water	N/A	2.03	+2.03
	RBSA NYSTA Dock	Open Water	N/A	0.80	+0.80
	Total	Open Water	10.25	5.53	-4.72
		Littoral Zone	0.13	1.15	+1.02
Adjacent Area		N/A	0.005	+0.005	
Total Temporary Overwater Coverage			10.38	6.69	-3.70
Permanent	RBSA North Dock	Open Water	2.19	2.44	+0.25
	RBSA North Dock Bulkhead	Open Water	N/A	0	0
	Total	Open Water	2.19	2.44	+0.25
		Littoral Zone	0	0	0
Total Permanent Overwater Coverage			2.19	2.44	+0.25
Notes: WBSA = Westchester Bridge Staging Area RBSA = Rockland Bridge Staging Area					

New NY Bridge Project

Table 6

Potential Loss of River Bottom, Wetlands, and Adjacent Area Habitats due to Project Activities (Replacement Bridge Alternative and Recommended Design)

Status	Activity / Use	USACE Wetland Areas (acres)		NYSDEC Littoral Zone Tidal Wetlands (acres)		NYSDEC Tidal Wetland Adjacent Area (acres)		Open Water Benthic Habitat (acres)	
		RBA	RD	RBA	RD	RBA	RD	RBA	RD
Temporary	WBSA North Platform	-	-	-	-	-	-	0.28	0.03
	WBSA South Platform	N/A	-	N/A	0.01	N/A	-	N/A	0.003
	WBSA Access Road	0.004	N/A	0.01*	N/A	0.01*	N/A	0.05	N/A
	RBSA Walkway	N/A	-	N/A	-	N/A	-	N/A	0.002
	RBSA North Platform	-	N/A	-	N/A	-	N/A	0.18	0.10
	RBSA South Platform	N/A	-	N/A	0.04	N/A	0.00003	N/A	0.02
	RBSA NYSTA Dock	N/A	-	N/A	-	N/A	-	N/A	0.001
	Dredging / Armoring	-	-	0.10	-	-	-	164.4-172.4/ 160-167**	139/107
	Total	0.004	0.0	0.11	0.05	0.01	0.003	164.9-172.9/160.5-167.5	139.16/107.16
	Permanent	RBSA North Dock (pile-supported)	-	-	-	-	-	-	0.11
RBSA North Dock Bulkhead		-	-	-	-	-	-	(0.10)	0.0
New Bridge		-	-	-	-	-	-	6.5-8.0	4.70
Removal of Existing Structure		-	-	-	-	-	-	(7.1)	(7.10)
Total		0	0	0	0	0	0	(0.54)-0.91	(2.28)
Notes: RBA = Replacement Bridge Alternative; RD = Recommended Design *Potential loss expressed as the area of the pile footprints supporting the overlying platform and access road for the FEIS Alternative; estimated as 5 percent of the platform area. **Short Span/Long Span Numbers in parentheses represent net gain. WBSA Westchester Bridge Staging Area RBSA Rockland Bridge Staging Area									